

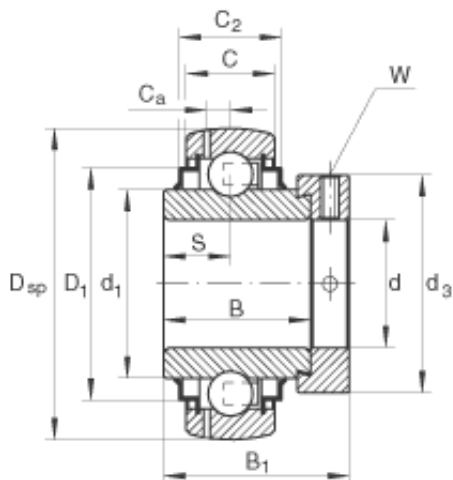

AMERICAN KOYO BEARING MFG.CORP.



GE55-KRR-B Bearing 2D drawings and 3D CAD models

INA GE55-KRR-B Ball Insert Bearings

Bearing No. GE55-KRR-B

Size	55x100x71.4 mm
Bore Diameter	55 mm
Outer Diameter	100 mm
Width	71,4 mm
d	55 mm
D _{SP}	100 mm
B ₁	71,4 mm
B	55,5 mm
C	25 mm
C ₂	29 mm
C _a	7 mm
D ₁	85,9 mm
d ₁	69,8 mm
d _{3max}	76 mm
S	27,8 mm
W	5 mm
m	1,37 kg / Weight
C _r	46000 N / Dynamic load rating (radial)
C _{0r}	29000 N / Static load rating (radial)
Category	Insert Bearings Spherical OD
Inventory	0.0
Manufacturer Name	SCHAEFFLER GROUP
Minimum Buy Quantity	N/A



AMERICAN KOYO BEARING MFG.CORP.

Weight / Kilogram	1.7
Product Group	M06110
Inner Race Profile	Wide Inner Ring
Outer Race Profile	Spherical
Relubricatable	Yes
Seal Type	Double Land Riding Rubber Contact
Mounting Method	Eccentric Collar
Rolling Element	Ball Bearing
Snap Ring	No
Long Description	55MM Bore; Wide Inner Ring; Ball Bearing; 71.4MM Length Thru Bore; 25MM Outer Race Width; 100MM Outside Diameter; Relubricatable; Double Land Riding Rubber Contact Seal; Eccentric Collar Mounting Meth
Inch - Metric	Metric
Other Features	Single Row With Set Screw Metric
Category	Insert Bearings
UNSPSC	31171536
Harmonized Tariff Code	8482.10.50.00
Noun	Bearing
Keyword String	Insert
Manufacturer URL	http://www.ina.com
Manufacturer Item Number	GE55KRRB
Weight / LBS	3.13
Outer Race Width	0.984 Inch 25 Millimeter
Bore	2.165 Inch 55 Millimeter
Length Thru Bore	2.811 Inch 71.4 Millimeter
Outside Diameter	3.937 Inch 100 Millimeter